

TWO DAYS –SAME LOCATION!

Event Numbers

SAT: 2012137405

SUN: 2012137406

ENTRIES CLOSE: 6:00 P.M. WEDNESDAY, FEBRUARY 8, 2012
Limited each day to the first 150 Conformation Entries

Virginia Torsch, Show Secretary
7608 Roanoke Ave
Annandale, VA 22003-5445
(703) 941-0902 ; Email: vtorsch2@juno.com

PREMIUM LIST

46th/47th Specialty Shows

Indoors - Unbenched

POTOMAC VALLEY SHETLAND SHEEPDOG CLUB, INC.

<http://www.PotomacValleySSC.com>

(American Kennel Club Licensed)



Catoctin Kennel Club Indoor Training Facility
4016 Rock Hall Road, Point of Rocks, Maryland 21777

Saturday, February 25, 2012

Sunday, February 26, 2012

Show Hours: 7:00 a.m. to 6:00 p.m.

These shows will be held under American Kennel Club Rules and Regulations

Virginia Torsch
PVSSC Show Secretary
7608 Roanoke Ave
Annandale, VA 22003-5445

Show Dates:

Saturday, February 25, 2012

Sunday, February 26, 2012

ENTRIES CLOSE:

Wednesday, February 8, 2012

ADVERTISING DEADLINES:

February 8, 2012

Dated Material-Please Deliver Promptly

SHOW COMMITTEE

| | |
|--|---------------------|
| Kenneth E. Stanley | Show Chair |
| 200 Ridgewood Court N.E., Vienna, VA 22180 Phone: (703) 281-1191 | |
| Virginia Torsch | Show Secretary |
| Ken Stanley | Publicity Chair |
| Jan Stanley | Trophy Committee |
| Ken Stanley | Catalog Sales |
| Cathie Skoog | Catalog Creation |
| Jan Stanley | Ribbons & Badges |
| Ken Stanley | Catalog Advertising |
| Lynne Beard | Chief Ring Steward |

JUDGES - SATURDAY, February 25, 2012

| | | |
|-------------------|---------------------------|---|
| | Sweepstakes | |
| Jennifer Johnston | | 37665 Piggott House Pl Purcellville, VA 20132 |
| | Junior Showmanship | |
| Carl R. Skinner | | 3921 Donner Tr Placerville, CA 95667 |
| | Conformation | |
| Carl R. Skinner | | 3921 Donner Tr Placerville, CA 95667 |

JUDGES - SUNDAY, February 26, 2012

| | | |
|---------------------|---------------------------|---|
| | Sweepstakes | |
| Michelle Brouse | | 9999 Patrick Henry Hwy Phenix, VA 23959 |
| | Junior Showmanship | |
| Patricia D. Skinner | | 3921 Donner Tr Placerville, CA 95667 |
| | Conformation | |
| Patricia D. Skinner | | 3921 Donner Tr Placerville, CA 95667 |

VETERINARIAN ON CALL

DR. KAREN MILLER, DVM
(301) 831-1110



Buckeystown Animal Hospital
3820 Buckeystown Pike
Buckeystown, MD 21717-0005

OFFICIAL PHOTOGRAPHER

Jim Poor Photography
(703) 347-4332



12813 Mill Meadow Ct
Fairfax, VA 22033
www.jimpoor.com

ONLY THE OFFICIAL PHOTOGRAPHER IS ALLOWED TO TAKE PICTURES IN THE RING.

AMERICAN KENNEL CLUB CERTIFICATION



*Permission has been granted by the American Kennel Club for the holding of this event under American Kennel Club rules and regulations.
James P Crowley, Secretary*

Catoctin Kennel Club Training Facility

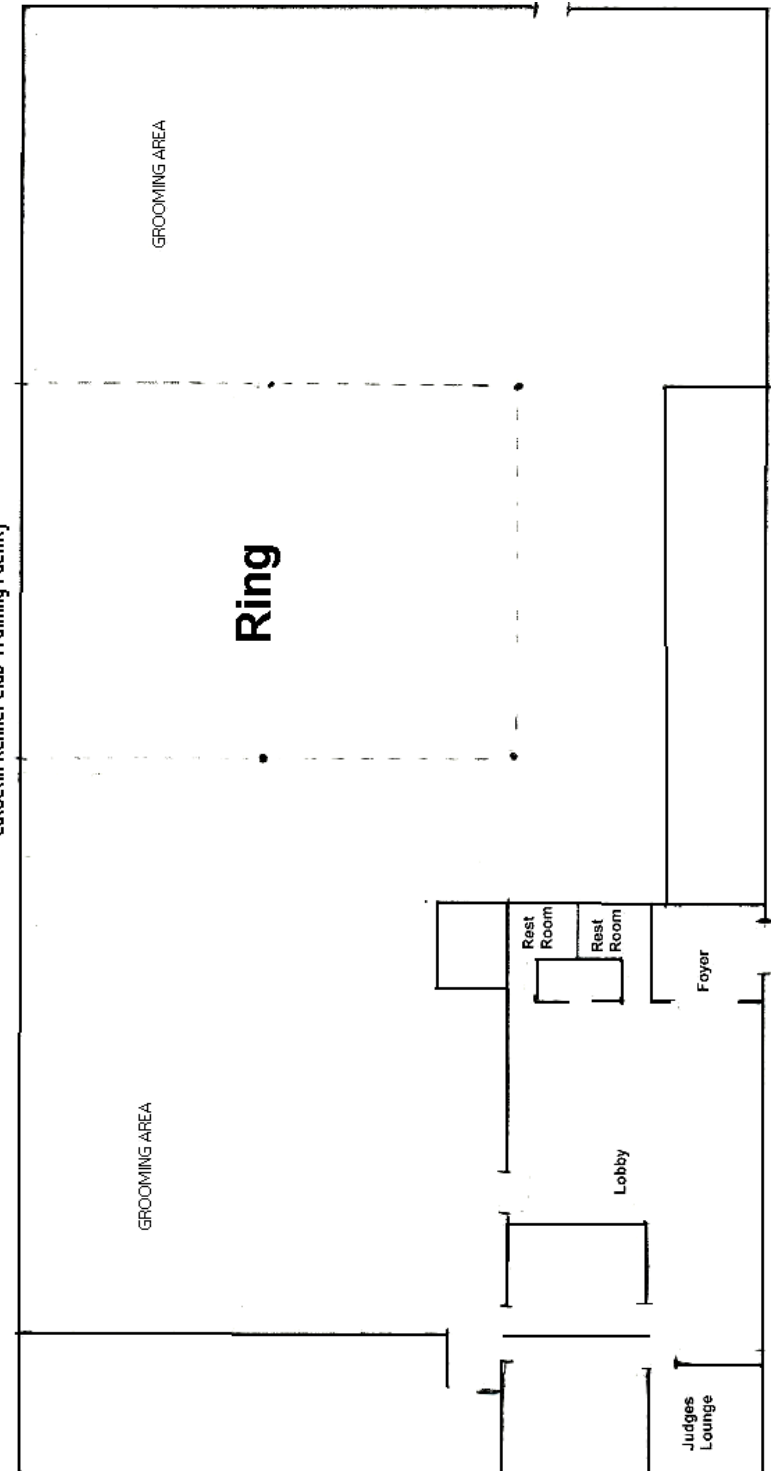

Entrance

AGREEMENT

I (we) agree that the club holding this event has the right to refuse this entry for cause which the club shall deem sufficient. In consideration of the acceptance of this entry and of the holding of this event and of the opportunity to have the dog judged and to win prizes, ribbons, or trophies, I (we) agree to hold the AKC, the event-giving club, their members, directors, governors, officers, agents, superintendents or event secretary and the owner and/or lessor of the premises and any provider of services that are necessary to hold this event and any employees or volunteers of the aforementioned parties, and any AKC approved judge, judging at this event, harmless from any claim for loss or injury which may be alleged to have been caused directly or indirectly to any person or thing by the act of this dog while in or about the event premises or grounds or near any entrance thereto, and I (we) personally assume all responsibility and liability for any such claim; and I (we) further agree to hold the aforementioned parties harmless from any claim for loss, injury or damage to this dog. Additionally, I (we) hereby assume the sole responsibility for and agree to indemnify, defend and save the aforementioned parties harmless from any and all loss and expense (including legal fees) by reason of the liability imposed by law upon any of the aforementioned parties for damage because of bodily injuries, including death at any time resulting therefrom, sustained by any person or persons, including myself (ourselves), or on account of damage to property, arising out of or in consequence of my (our) participation in this event, however such, injuries, death or property damage may be caused, and whether or not the same may have been caused or may be alleged to have been caused by the negligence of the aforementioned parties or any of their employees, agents, or any other persons. **I (WE) AGREE THAT ANY CAUSE OF ACTION, CONTROVERSY OR CLAIM ARISING OUT OF OR RELATED TO THE ENTRY, EXHIBITION OR ATTENDANCE AT THE EVENT BETWEEN THE AKC AND THE EVENT-GIVING CLUB (UNLESS OTHERWISE STATED IN ITS PREMIUM LIST) AND MYSELF (OURSELVES) OR AS TO THE CONSTRUCTION, INTERPRETATION AND EFFECT OF THIS AGREEMENT SHALL BE SETTLED BY ARBITRATION PURSUANT TO THE APPLICABLE RULES OF THE AMERICAN ARBITRATION ASSOCIATION. HOWEVER, PRIOR TO ARBITRATION ALL APPLICABLE AKC BYLAWS, RULES, REGULATIONS AND PROCEDURES MUST FIRST BE FOLLOWED AS SET FORTH IN THE AKC CHARTER AND BYLAWS, RULES, REGULATIONS, PUBLISHED POLICIES AND GUIDELINES.**

INSTRUCTIONS

1. (Variety) if you are entering a dog of breed in which there are varieties for show purposes, please designate the particular variety you are entering, i.e., Cocker Spaniel (solid color black, ASCOB, parti-color), Beagles (not exceeding 13 in., over 13 in. but not exceeding 15 in.), Dachshunds (longhaired, smooth, wirehaired), Collies (rough, smooth), Bull Terriers (colored, white), Manchester Terriers (standard, toy), Chihuahuas (smooth coat, long coat), English Toy Spaniels (King Charles and Ruby, Blenheim and Prince Charles), Poodles (toy, miniature, standard).
2. The following categories of dogs may be entered and shown in Best of Breed competition: Dogs that are Champions of Record and dogs which, according to their owners' records, have completed the requirements for a championship, but whose championships are unconfirmed. The showing of unconfirmed Champions in Best of Breed competition is limited to a period of 90 days from the date of the show where the dog completed the requirements for a championship.
3. (Event Class) Consult the classification in this premium list. If the event class in which you are entering your dog is divided, then, in addition to designating the class, specify the particular division of the class in which you are entering your dog, i.e. age division, color division, weight division.
4. A dog must be entered in the name of the person who actually owned it at the time entries for an event closed. If a registered dog has been acquired by a new owner it must be entered in the name of its new owner in any event for which entries closed after the date of acquirement, regardless of whether the new owner has received the registration certificate indicating that the dog is recorded in his name. State on entry form whether transfer application has been mailed to the AKC. (For complete rules, refer to Chapter 11, Section 3.)

If this entry is for Jr. Showmanship, please give the following information:

JUNIOR SHOWMANSHIP JR.'S DATE OF BIRTH: _____

AKC JUNIOR HANDLER NUMBER

The above number MUST be included. Should you not have your Junior Handler number, this may be obtained from the American Kennel Club. Phone (919) 233-9767.

By signing the entry form I (we) certify that the Junior Showman does not now, and will not at any time, act as an agent/handler for pay while continuing to compete in Junior Showmanship.

ADDRESS: _____

CITY _____ STATE _____ ZIP _____

If Jr. Handler is not the owner of the dog identified on the face of this form, what is the relationship of the Jr. Handler to the Owner?

Officers:

| | |
|---------------------------|--------------------------|
| President | Jan Stanley |
| Vice President | Cathie Skoog |
| Recording Sec. | Deborah Lauritzen |
| Corresponding Sec. | Ken Stanley |
| Treasurer | Jack Gurney |

Directors:

| | |
|-----------------|-----------------------|
| Director | Fran Beacham |
| Director | Marilyn Manser |

TROPHIES

A listing of all trophies is available upon request (to Jan Stanley, 200 Ridgewood Ct. N.E., Vienna, VA 22180), and will be printed in the catalog. An ASSA Medallion will be awarded to the Winners Dog and Winners Bitch.

ENTRY FEES

| | |
|---|----------------|
| First Class in which a dog is entered | \$28.00 |
| Each Additional Class for same dog | \$18.00 |
| Sweepstakes (as an additional class ONLY) | \$12.00 |
| Veterans | \$12.00 |
| Puppy Classes (Up to 12 months) | \$18.00 |
| Junior Showmanship (Free as an additional Class, otherwise:) | \$12.00 |

First Entry Fee includes \$3.00 AKC Event Service Fee & \$0.50 AKC Recording Fee. 12-18 mo. Junior Classes are considered ADULT DOGS.

BRED-BY-EXHIBITOR CLASS ELIGIBILITY

All dogs entered in the Bred-By Class must be individually registered with the AKC. The person handling the dog must be a breeder of record of the dog and an owner of record of the dog.

To exhibit in this class, family members must be a breeder and owner of record.

CLASSIFICATIONS

REGULAR CLASSES

- | | |
|--------------------------------------|---|
| Puppy Dogs, 6 months under 9 months | Puppy Bitches, 6 months under 9 months |
| Puppy Dogs, 9 months under 12 months | Puppy Bitches, 9 months under 12 months |
| Dogs, 12 months and under 18 months | Bitches, 12 months and under 18 months |
| Bred By Exhibitor Dogs | Bred By Exhibitor Bitches |
| American Bred Dogs | American Bred Bitches |
| Open Dogs, Black | Open Bitches, Black |
| Open Dogs, Blue | Open Bitches, Blue |
| Open Dogs, Sable and White | Open Bitches, Sable and White |
| Winners Dog | Winners Bitch |

Eligibility for Regular Classes is to be determined by AKC Rules.

BEST OF BREED

BEST OF BREED COMPETITION - "The following categories of dogs may be entered and shown in Best of Breed Competition: Dogs that are Champions of record, which according to their owners' records have completed the requirements for a championship but whose championships are unconfirmed. The entry and showing of dogs whose championships are unconfirmed is limited to a period of 90 days from the date of the show where a dog completed the requirements for a championship according to the owners' records. If, at the end of the 90 days period, the championship of a dog has not been confirmed by The American Kennel Club, no further entries of the dog for Best of Breed competition are to be made until its championship has been confirmed by the AKC".

NON-REGULAR CLASSES INVOLVING SINGLE DOG ENTRIES

- | | | |
|----------------------|---------------------------------------|-------------------------|
| *Veteran Dogs | For Shelties 8 years through 11 years | *Veteran Bitches |
| *Veteran Dogs | For Shelties 12 years and older | *Veteran Bitches |

*Chapter 11, Section 8 of the Dog Show Rules provides that "Neutered dogs and spayed bitches would be allowed to compete in the Veterans classes only at independent specialties and/or those all-breed shows which do not offer any competitive classes beyond Best of Breed."

NON-REGULAR CLASSES, INVOLVING MULTIPLE DOG ENTRIES (NOT OFFERED)

*STUD DOG CLASS: For Stud dogs and two but not more than five of their get. Stud Dogs must be entered in the Stud Dog Class and must be shown in the ring with their get. The owner of the stud dog need not necessarily be owner of the get. While the merits of the stud dog are not to be considered in the placement of the entry, the stud dog must be examined to determine if it has a condition that would require its disqualification or excused under the Dog Show Rules, AKC policy, or the standard for its breed. Get must be entered in a regular class, Best of Breed Competition, or some other non-regular class.

*BROOD BITCH CLASS: For Brood Bitches and two but not more than five of their produce. Brood Bitches must be entered in the Brood Bitch Class and must be shown in the ring with their produce. The owner of the brood bitch need not necessarily be owner of the produce. While the merits of the brood bitch are not to be considered in the placement of the entry, the brood bitch must be examined to determine if it has a condition that would require its disqualification or excused under the Dog Show Rules, AKC policy, or the standard for its breed. Produce must be entered in a regular class, Best of Breed Competition, or some other non-regular class.

*Chapter 11, Section 8 of the Dog Show Rules provides that "a castrated male may be entered as Stud Dog in the Stud Dog Class and a spayed bitch may be entered as Brood Bitch in the Brood Bitch Class".

SWEEPSTAKES (NON-REGULAR) REQUIREMENTS & CLASSIFICATION

Open to all Shetland Sheepdog puppies, who, on the day of the show, will be 6 months of age and under 18 months of age. No AKC Champion of Record may be shown. Dogs shown in Sweepstakes must also be entered and exhibited in one of the regular classes. Indicate your Sweepstakes Class with age division in the space provided for "Additional Classes."

The following classes will be provided for both dogs and bitches:

- Puppy, 6 Months & Under 9 Months
- Puppy, 9 Months & Under 12 Months
- Junior, 12 Months & Under 18 Months

DIVISION OF ENTRY MONEY AS PRIZES

- 35% of total entry fees will be retained by the Club for expenses. The remaining 65% will be divided as follows:
- Best in Sweepstakes.....20% of Sweepstakes Entries
 - Runner-Up to Best in Sweepstakes ...15% of Sweepstakes Entries
 - First in Each Class5% of Sweepstakes Entries

**OFFICIAL AMERICAN KENNEL CLUB ENTRY FORM
POTOMAC VALLEY SHETLAND SHEEPDOG CLUB, INC.**

- | | |
|--|--|
| <input type="checkbox"/> Sat., February 25, 2012 (2012137405) | <input type="checkbox"/> Sun., February 26, 2012 (2012137406) |
|--|--|

Catoctin Kennel Club Training Facility 4016 Rock Hall Road, Point of Rocks, Maryland 21777
Entries Limited each day to first 150 Conformation.

Entry Fees: \$28 for first entry of a dog. Additional class for same dog, \$18. Veterans, \$12, Sweepstakes, \$12. Puppy Classes (up to 12 months), \$18. Junior Showmanship, free as an additional Class, otherwise, \$12. First Entry Fee includes \$3.00 AKC Event Service Fee & \$ 0.50 AKC Recording Fee.

ENTRIES CLOSE: 6:00 P.M. WEDNESDAY, FEBRUARY 8, 2012 at the home of the Show Secretary
Checks payable to: PVSSC; Mail to: Virginia Torsch, 7608 Roanoke Dr, Annandale, VA 22003-5445
Conditional, Unsigned or Incomplete entries or entries received without fees will not be accepted.
Telephone or telegraph entries are not acceptable. All cancellations must be written and received by the Show Secretary before closing date.

I Enclose \$_____ for entry fees. I include \$4 for Catalog __ (limited # at \$5 on-site)
Please typewrite or print with black ink. Read instructions opposite or on reverse side before filling out!
Numbers in the boxes indicate sections of the instructions relevant to the information needed in that box.

| | | |
|---|--|--|
| BREED <u>Shetland Sheepdog</u> | VARIETY 1 | SEX |
| DOG 2 3 SHOW CLASS | CLASS 3 DIVISION Weight, color, etc. | |
| ADDITIONAL CLASSES | OBEDIENCE CLASS | RALLY CLASS (jump Height) |
| | | JR. SHOWMANSHIP CLASS |

| | |
|---|-------------------------------------|
| NAME OF (See Back) JUNIOR HANDLER (if any) | JR. HANDLER NUMBER |
|---|-------------------------------------|

| | |
|---|--------------------------------|
| FULL NAME OF DOG | DATE OF BIRTH |
|---|--------------------------------|

| | |
|---|---|
| <input type="checkbox"/> AKC REG NO. Enter number here <input type="checkbox"/> AKC LITTER NO. <input type="checkbox"/> ILP NO. <input type="checkbox"/> FOREIGN REG NO & COUNTRY | PLACE OF <input type="checkbox"/> USA <input type="checkbox"/> Canada <input type="checkbox"/> Foreign BIRTH <small>Do not print the above in the catalog.</small> |
|---|---|

| |
|----------------|
| BREEDER |
|----------------|

| |
|-------------|
| SIRE |
|-------------|

| |
|------------|
| DAM |
|------------|

| | |
|--------------------------------|-------------------------------------|
| ACTUAL OWNER(S) 4 _____ | <small>(Please Print!)</small> |
| OWNER'S ADDRESS _____ | |
| CITY _____ | STATE _____ ZIP _____ |

| |
|---|
| NAME OF OWNER'S AGENT (IF ANY) AT THE SHOW _____ |
|---|

I CERTIFY that I am the actual owner of the dog, or that I am the duly authorized agent of the actual owner whose name I have entered above. In consideration of the acceptance of this entry, I (we) agree to abide by the rules and regulations of The American Kennel Club in effect at the time of this event, and by any additional rules and regulations appearing in the premium list for this event, and further agree to be bound by the "Agreement" printed on the reverse side of this entry form. I (we) certify and represent that the dog entered is not a hazard to persons or other dogs. This entry is submitted for acceptance on the foregoing representation and Agreement. I (we) agree to conduct myself (ourselves) in accordance with all such Rules and Regulations (including all provisions applying to discipline) and to abide by any decisions made in accord with them.

SIGNATURE of owner or
his agent duly authorized to make this entry _____
TELEPHONE# _____

E-MAIL Address (An acknowledgment or receipt of entry may be sent to this e-mail address): _____

ADDITIONAL RULES

1. Owners and owners' agents are responsible for any errors on entry forms, for entering the same dog twice, or for entering a dog in a class for which it is not eligible. Entry fees will not be refunded in the event of errors or cancellations received after the close of entries. Telephone, Telegraph, Fax and unsigned entries cannot be accepted.
2. Entry fees shall not be refunded in the event that a dog is absent, disqualified, excused, by Veterinarian or Judge, or barred from competition by action of the event's Show Committee. If because of riots, wars, strikes, civil disturbances, national emergencies, health emergencies, and dictates of law enforcement or of the owners(s) of the grounds and/or facilities, or other acts, events or conditions beyond the control of the management it is impossible or imprudent in the Club's discretion, to open, hold, or complete the shows, no refund of entry fees will be made. Extreme weather conditions, such as, but not limited to snow storms, hurricanes, lightning, extreme heat, heavy rains, or other circumstances including, but not limited to, the condition of the facilities or grounds and/or ingress and egress from the grounds, must be considered for health and safety of the dogs, exhibitors and spectators. The well-being of the dogs, exhibitors and spectators is of paramount importance and, in the event it is necessary to cancel or stop the show before completion, no refund of entry fee will be made. No refunds for Bitches in Season entered in Obedience.
3. This show will be Unbenched. Exhibitors should bring their dogs to the show grounds in plenty of time before the scheduled time of judging and may be excused after their class is judged, if they are not needed for further judging. Dogs MUST compete in every class in which they are entered or for which they become eligible.
4. Dogs must be ready for judging. Owners or owners' agents are solely responsible for the presence of their dogs in the judging ring at the proper time. The Club and/or the Show Secretary will not be responsible for and are not obligated to provide a service for notifying exhibitors of breed or class judging. Judges will not wait for dogs holding up their rings.
5. The Club and management will not be responsible for the loss or damage to any dogs, on or off the show grounds, whether the result of accident or any other cause. It is to be distinctly understood by all exhibitors that their dogs are to be in their custody and care at all times.
6. The Club may decline any entries for cause and may refuse to receive or may remove any dog on account of disease, viciousness or other causes, and no one shall have any claim or recourse against the Club or any official thereof.
7. There will be NO exercise pens allowed inside the building and no crates or grooming tables allowed within ten (10) feet of any ring. All grooming must be done in areas specified by the club and exhibitors are required to clean-up their areas. Posted restrictions on the use of the rest rooms are to be obeyed.
8. Trophies and other Prizes will be awarded in the judging rings unless otherwise specified by the club. All claims for Trophies and other prizes must be made in the judging ring before completion of judging by the person handling the dog; such person shall be considered as the owner or owner's agent. The Show Secretary is to be notified at once in the event of any discrepancies. No trophies will be mailed.
9. Only dogs that are eligible to be shown under The American Kennel Club rules shall be allowed within the show precincts [AKC Rules Applying to Dog Shows: Ch. 11, Sec. 11.] PLEASE NO UNDERAGE PUPPIES. There are no provisions for dogs not entered.
10. A recording fee of 50 cents will be required for each dog at any licensed or member club show, obedience trial or tracking test. This recording fee is to be collected by the show-giving club and paid to the AKC. If a dog is entered in more than one class at a show, the recording fee is to be collected on the first entry only. AKC Rule, Ch. 11, Section 2.
11. The Show Giving Club, Show Secretary, their agents, employees, etc. assume no responsibility for any loss, damage, or injury sustained by exhibitors, handlers, or to any of their dogs or property and further assume no responsibility for injury to any children.
12. Returned checks do not constitute a valid entry fee. PVSSC may assess a collection fee; the amount charged by the bank, will be added to the amount of each returned check. Subsequent returned checks from the same person will result in their being put on a cash only basis.
13. Unruly and disruptive exhibitors and/or spectators will be asked to leave the Show and/or may be subject to a Show Committee Disciplinary Hearing.

NOTICE TO EXHIBITORS

American Kennel Club Rules Applying To Dog Shows, Chapter 11, Section 6: "No entry may be changed or canceled unless notice of the change or cancellation is received in writing or by telegram by the Secretary or Show Secretary named in the premium list to receive entries, prior to the closing date and hour for entries, except that a correction may be made in the sex of a dog, or a dog may be transferred from one division of the Puppy Class to another at a show prior to the judging, and except that dogs which according to their owner's records have completed the requirements for a championship after the closing of entries for a show, but whose championships are unconfirmed, may be transferred from one of the regular classes to the Best of Breed or Variety competition, provided this transfer is made by the Secretary or Show Secretary at least one half hour prior to the scheduled start of any regular conformation judging at the show."

JUNIOR SHOWMANSHIP

The Regular Junior Showmanship Classes shall be:

- (A) **Novice.** This shall be for boys and girls who are at least 9 years old and under 18 years old on the day of the show and who at the time entries close have not won three (3) first place awards, with competition present, in a Novice Class at a licensed or member show.
- (B) **Open.** This class shall be for boys and girls who are at least 9 years old and under 18 years old on the day of the show, and who have won three first place awards in a Novice Class in a licensed or member show, with competition present in the Novice class. Juniors which according to their records have completed the requirements to compete in the Open class but whose status is unconfirmed by the American Kennel Club are limited to competing in the Open Class for a period of 90 days from the date of the show where the Junior completed the requirement according to their records.
- (C) **Master.** This class will be for boys and girls who are at least 9 years old and under 18 years on the day of the show, and who have won the 10 first place wins in an Open Class Competition. The calendar for this class will be November 1- October 31 of the following year. All Juniors meeting the criteria for this class are required to enter the Master Class and may change their entry without charge the day of the show if entries have already closed. Once the eligibility time frame for that year has passed all participants return to the Open Class to compete for the following year."

NOTICE: Junior Handlers must include their JUNIOR HANDLER NUMBER on each entry.

You may obtain your junior identification number by calling AKC, Judges Education Department, (919) 816-3776

BE SURE ALL INFORMATION for Junior Showmanship classes is entered on front and back of the entry form.

RIBBONS

REGULAR CLASSES

| | |
|--|---|
| First Prize -- Blue Rosette | Second Prize -- Red Ribbon |
| Third Prize -- Yellow Ribbon | Fourth Prize -- White Ribbon |
| Winners -- Purple Rosette | Reserve Winners -- Purple & White Rosette |
| Best of Winners -- Blue & White Rosette | |
| Best of Breed -- Purple & Gold Rosette | |
| Best of Opposite Sex to Best of Breed -- Red & White Rosette | |
| Select -- Light Blue & White Rosette | |
| Champion Finishing at Specialty - Blue & Gold Rosette | |
| Grand Champion Finishing at Specialty -- Teal & Gold Rosette | |

NON-REGULAR CLASSES

| | |
|--|------------------------------|
| First Prize -- Rose Ribbon | Second Prize -- Brown Ribbon |
| Third Prize -- Light Green Ribbon | Fourth Prize -- Gray Ribbon |
| First Prize in Junior Showmanship -- Rose Rosette | |
| First Prize in Veteran Dog & Bitch Classes -- Rose Rosette | |

SWEEPSTAKES

The club offers, in colors as designated for Non-Regular classes, ribbons for 1st to 4th in each class and rosettes for Best in Sweepstakes and Runner Up to Best in Sweepstakes

| |
|--|
| Best In Sweepstakes -- Pink & Green Rosette |
| Runner Up To Best In Sweepstakes -- Green & Pink Rosette |

Catalog Advertising

We encourage your placing an ad in our Catalog for upcoming events, your kennel, or your business!

All advertisements are subject to acceptance by PVSSC.

| | |
|--------------------|---------|
| Double Page | \$35.00 |
| Full Page | \$25.00 |
| Half Page | \$15.00 |
| Quarter Page | \$10.00 |
| Business Card | \$ 8.00 |
| Inside Front Cover | \$35.00 |
| Inside Back Cover | \$35.00 |
| Outside Back Cover | \$40.00 |

Payment MUST accompany ad copy. Make checks payable to PVSSC.

Mail to:

Ken Stanley
200 Ridgewood Ct NE
Vienna, VA 22180-3571

Questions to: stanktwo@gmail.com

ADVERTISING DEADLINE: FEBRUARY 8, 2012

To get personalized directions from your home to the show site, click on the map linked with Show Information on our website (www.PotomacValleySSC.com)

Directions to the Show Site

The site is 12 miles SW of Frederick, MD and 13 miles north of Leesburg, VA

- (1) FROM THE NORTH: Proceed to Frederick; take MD340/15 south approx. 4 miles to MD-15 turnoff to Leesburg and Point of Rocks. At Point of Rocks, before crossing the Potomac River, turn left on MD-28. The Catoctin Kennel Club Training Facility is about 1 mile on the south (right) side of MD-28 in a big brick building with parking in the rear.
- (2) FROM the NORTHEAST AND EAST: Take I-95 to I-695 toward Towson to I-70 West to Frederick, take exit 52 to MD 340/15 South (toward Leesburg and Point of Rocks). Proceed as in (1).
- (3) FROM THE SOUTHEAST: Take I-95 to I-495 to I-270 North toward Rockville to MD-28 West. Proceed 24 miles (15 lights, under railroad tracks and over a bridge). Where MD-28 makes a sharp left turn to Point of Rocks and MD-85 goes north to Frederick. Proceed for four miles on MD-28 to the Catoctin Kennel Training Facility on the left side of MD-28.
- (4) FROM THE SOUTH and SOUTHWEST: Take Rt. 15 north to cross the Potomac River at Point of Rocks, turn right on MD-28. Follow the rest of the directions in 1.

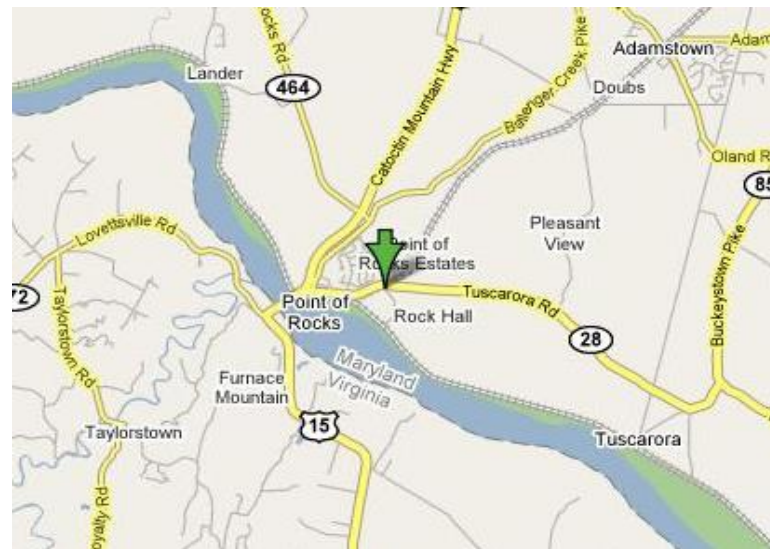

ACCOMMODATIONS

We recommend the following "Pet Friendly" hotels. Ask for the PVSSC Group Rate. If the PVSSC Group Rate is no longer available (best to book early), try to obtain a AAA, AARP, or other Affinity Group Rate in which you hold membership. Please be considerate so that we may continue to use these facilities.

Holiday Inn Express, 5579 Spectrum Dr, Frederick, MD, (800) 626-9849 (\$50 refundable pet deposit plus \$10 pet fee required)

Best Western, 726 E Market St, Leesburg, VA 20176, (703) 777-9400 (\$10 pet fee required)

Days Inn, 721 E Market St, Leesburg, VA 20176, (703) 777-6622 (\$6.00 pet fee required)